



South Bay Foundry

WWW.SOUTHBAYFOUNDRY.COM

PHONE: (619) 956-2780 FAX: (619) 956-2788

SBF 1900

**24" FRAME AND COVER
SAC. AREA SEWER DIST.
ID# A5001 / A5315**

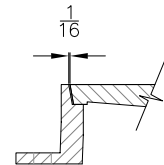
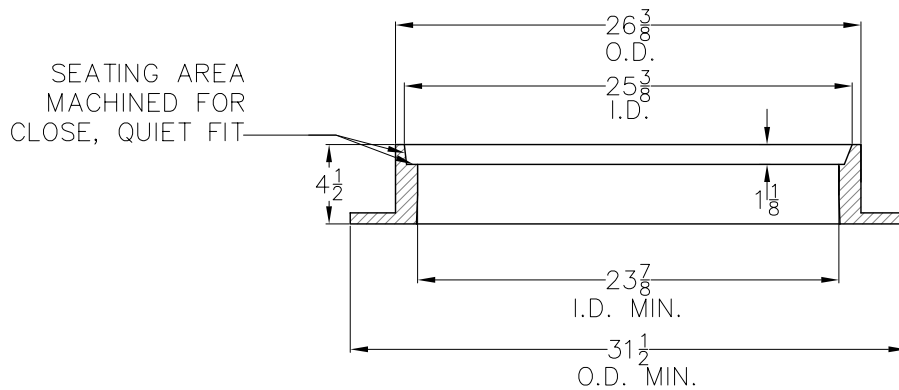
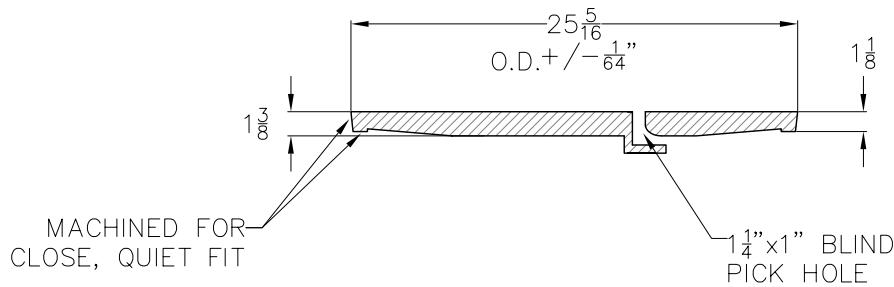
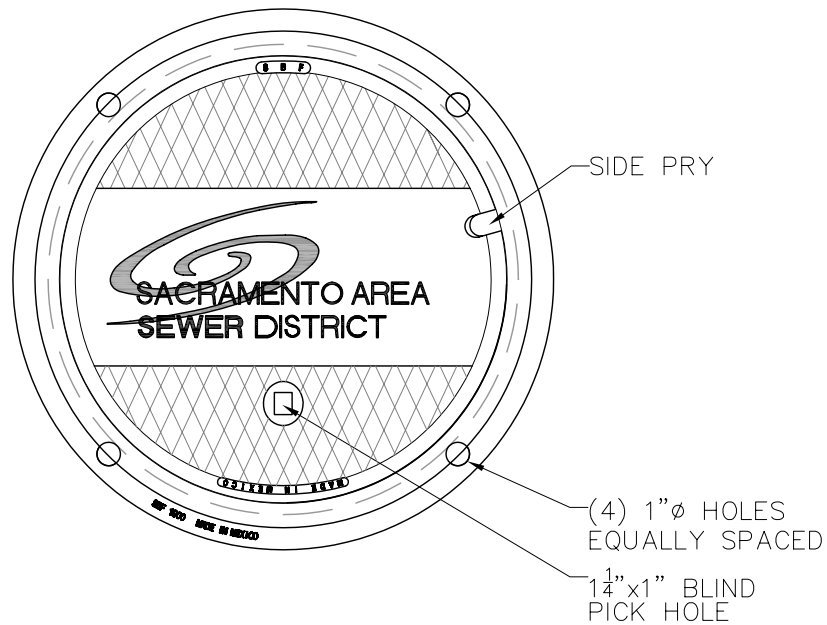

FRAME AND COVER SEATING

GENERAL INFORMATION

- *All materials used in manufacturing shall conform to ASTM 48. Class 35B.
- *Frame and cover bearing surfaces shall be machined to assure close, quiet fit.
- *Frame and cover exceeds H-20 wheel loading.

APPROVED

BY:

TITLE:

AGENCY:

DATE:

04-30-10